

# Hydrogard® ES Series

## Energy Saver Cycling

## Refrigerated Dryer

2,500 - 12,000 scfm



Shown with water-cooled condenser

ES Series refrigerated dryers use a simple cycling dryer design to dry high volumes of compressed air. Large flow ES Series refrigerated dryers include a simple refrigeration design to cool a liquid solution. The compressed air is then cooled as it passes through this liquid solution.

### Features and Benefits

- **Efficient refrigeration compressors** reduce operating costs and provide years of trouble-free operation
- **Suction valve unloaders** match refrigeration compressor performance to actual compressed air loading, thus minimizing power consumption while maintaining accurate dew point control
- **Energy efficient precooler/reheater** reduces the refrigeration compressor horsepower by 50% or more and eliminates all downstream pipeline sweating
- **Heat exchangers feature** smooth, self-cleaning, copper tube construction, which provide reduced operating costs by minimizing pressure drop and eliminating the need for filtration prior to the dryer
- **Moisture separator** is 99% efficient in complete separation of the condensed moisture. Dew point deterioration due to moisture carryover is eliminated
- **Environmentally safe** cooling solution eliminates freeze-up potential
- **Dual electronic drain valves** allow for automatic moisture drainage and clog-free operation

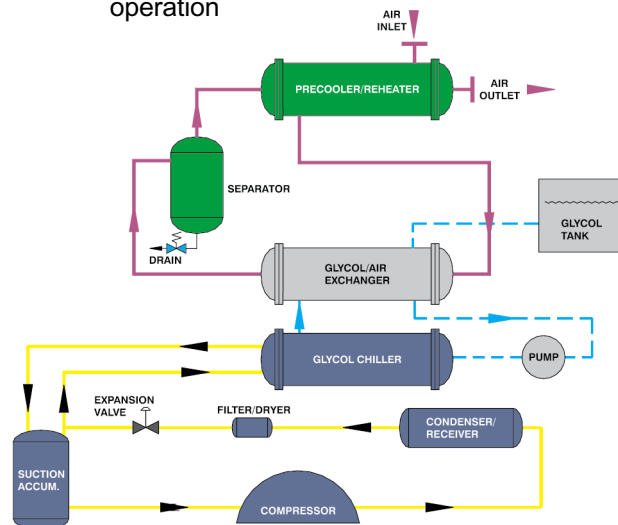

- **Environmentally friendly R-22** refrigerant prevents the problem of atmospheric ozone depletion associated with other refrigerants
- **System Operation Monitor (SOM)** is a microprocessor-based controller that controls dryer operation and features:

- Critical air and refrigerant temperatures
- Electronic drain valve control
- Visual display of operating status
- RS-232 port and dry auxiliary alarm contact for remote communication

# DELTECH

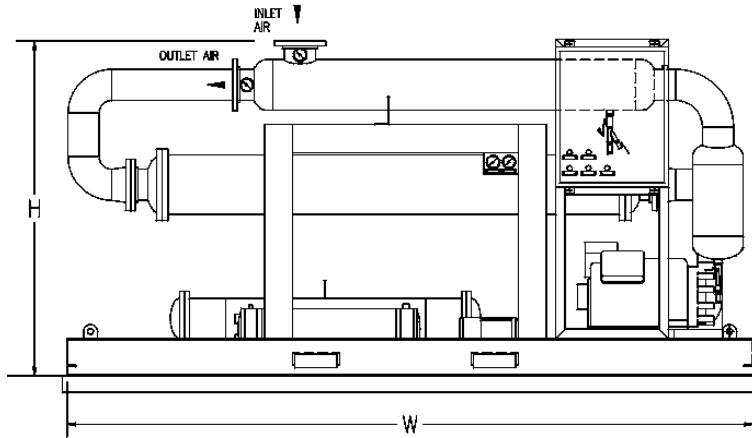
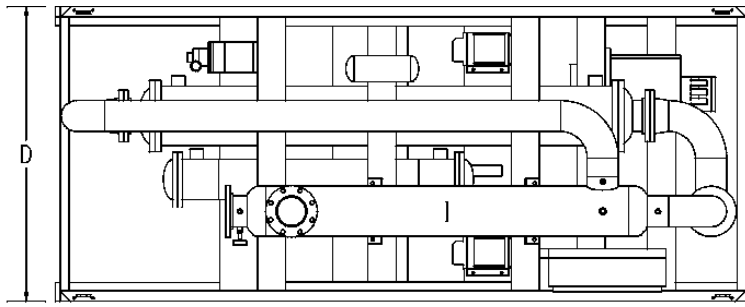

Model	Capacity <sup>1</sup> scfm (Nm <sup>3</sup> /min)	Dimensions inches (cm)			Inlet/Outlet Connections (inches) (150# FLG)	Cooling Air (cfm)	Compressor (hp)	Unit RLA	Average Unit kW <sup>2</sup>	Approx. Shipping Weight lbs (kg)
		H	L	W						
ES2500	2,500 (71)	72 (183)	149 (379)	60 (152)	6	9,500	14.4	15.3	8.3	6,300 (2,864)
ES3250	3,250 (92)	74 (188)	121 (307)	60 (152)	6	9,500	15.0	26.1	13.7	6,500 (2,955)
ES4000	4,000 (113)	79 (201)	125 (318)	60 (152)	8	15,300	20.0	23.0	11.1	10,100 (4,591)
ES5000	5,000 (142)	79 (201)	154 (391)	60 (152)	8	15,600	22.0	33.7	14.8	12,400 (5,637)
ES6250	6,250 (180)	90 (229)	160 (406)	66 (168)	8	C/F	30.0	36.9	20.0	15,150 (6,886)
ES8250	8,250 (234)	95 (241)	160 (406)	68 (173)	8	C/F	35.0	46.5	25.2	16,000 (7,273)
ES10000	10,000 (283)	106 (269)	172 (437)	77 (196)	10	Consult Factory				23,000 (10,455)
ES12000	12,000 (340)	111 (282)	196 (498)	81 (206)	12					28,800 (13,091)

<sup>1</sup> Performance data obtained in accordance with CAGI Standard No. ADF 100 "Refrigerated Compressed Air Dryers - Methods for Testing and Rating." Rating conditions are 100°F (37.8°C) inlet temperature, 100 psig (6.9 barg) inlet pressure, 100% relative humidity, 100°F (37.8°C) ambient temperature and 5 psi (0.35 bar) pressure drop

<sup>2</sup> Unit kW is shown for an water-cooled unit.  
CF - Consult Factory

ISO9001



**DELTECH**

A United Dominion Company  
Flair Industrial Air

4647 SW 40th Ave.  
Ocala, FL 34474-5799  
Tel 352 873-5700  
Fax 352 873-5744  
Email deltech@udi-flair.com  
www.udi-flair.com/deltech

**U.S. Facilities**  
Ocala, Florida  
New Castle, Delaware  
Stanley, North Carolina

**Canadian Facilities**  
Brockville, Ontario  
Blainville, Quebec  
Tel 800 893-5247  
Fax 800 318-0952

**European Facilities**  
Hordean, Hants, England  
Dortmund, Germany  
Killarney, Ireland  
Etten-Leur, The Netherlands

**Asian Facilities**  
Jaipur, India  
Vadodara, India  
Tokyo, Japan  
Pusan, Korea