

In the following parts list, assemblies are printed in capital letters. Parts that are included with an assembly are listed and indented directly beneath it. When an assembly is ordered, the assembly and all parts indented beneath it are included in the shipment.

When an assembly lists a letter code in the **USED ON** column, parts that list the same letter code are used in that assembly. Parts coded **A** are used in the Assembly coded **A**, parts coded **B** are used in the Assembly coded **B**, etc.

ITEM	DESCRIPTION	PART NO.	QTY	USED ON
1	OPTIONAL MECHANICAL SERVICE INDICATOR ASSY	5797-50	1	
2	• Screw	9F08-15	2	
3	• Body, nylon	Not available separately-order item 1	1	
4	• Ring support	Not available separately-order item 1	1	
5	• Diaphragm	Not available separately-order item 1	1	
6	OPTIONAL ELECTRICAL SERVICE INDICATOR ASSY	4020-51R	1	
7	• Screw	9F08-15	2	
8	• Switch	Not available separately-order item 6	1	
9	• Seal	Not available separately-order item 6	1	
9A	• Seal	Not available separately-order item 6	1	
10	• Connector Assy	4347-01	1	
11	• • Screw	Not available separately-order item 10	1	
12	• • Seal	Not available separately-order item 10	1	
13	Plug, pipe, 1/4 PTF (service kit item)	2891-97	1	
	Plug, pipe, ISO R1/4 (service kit item)	2845-02	1	
14	Body	Not normally replaced	1	
15	Intermediate Body, used with standard element, equipped with internal lugs to mount bowls 20 and 33	Not normally replaced	1	
15A	Intermediate Body, used with standard element, equipped with internal threads to mount bowls 46 and 61	Not normally replaced	1	
16	Intermediate Body, used with high flow element, equipped with internal lugs to mount bowls 20 and 33	Not normally replaced	1	
16A	Intermediate Body, used with high flow element, equipped with internal threads to mount bowls 46 and 61	Not normally replaced	1	
17	O-ring (F47 service kit item)	2307-60	1	
18	Element, standard, 6.5" (164mm) long (F47 service kit item)	3203-01	1	
	Element, high flow, 14.3" (363mm) long (F47 service kit item)	3203-04	1	
19	• O-ring (F47 service kit item)	2307-33	1	
20	METAL BOWL ASSY, CURRENT CONFIGURATION, use with item 15 or 16			
	METAL BOWL ASSY, Sight glass, 1/4 turn manual drain	4303-51R	1	A
	METAL BOWL ASSY, Sight glass, automatic drain	4303-52R	1	B
21	• MANUAL DRAIN ASSY, 1/4 turn	619-50	1	A
22	• • Valve, drain	617-89	1	A
23	• • O-ring	2317-05	1	A
24	• AUTOMATIC DRAIN ASSY, 1/8 PTF Outlet *	3000-10	1	B
25	• • Nut	2797-89	1	B
26	• • Gasket (F47 service kit item)	2811-01	1	B
27	• Screw (4380-050 service kit item)	9P06-12	2	AB
28	• Clamp, sight glass	4323-01	1	AB
29	• Lens, sight glass (4380-050 service kit item)	4321-88	1	AB
30	• Seal, sight glass lens (4380-050 service kit item)	4322-87	1	AB
31	• O-ring, bowl (4380-050 service kit item) (F47 service kit item)	2316-38	1	AB
32	• Bowl, metal	Not normally replaced	1	AB
33	METAL BOWL, 1996 CONFIGURATION, use with item 15 or 16 Replaced by item 20			
34	• MANUAL DRAIN ASSY, 1/4 turn	619-50	1	
35	• • Valve, drain	617-89	1	
36	• • O-ring	2317-05	1	
37	• AUTOMATIC DRAIN ASSY, 1/8 PTF Outlet *	3000-10	1	
38	• • Nut	2797-89	1	
39	• • Gasket (F47 service kit item)	2811-01	1	
40	• Screw (4380-050 service kit item)	9P06-10	2	
41	• Clamp, sight glass	4323-01	1	
42	• Lens, sight glass (4380-050 service kit item)	4321-89	1	
43	• Seal, sight glass lens (4380-050 service kit item)	4322-99	1	
44	• O-ring, bowl (4380-050 service kit item) (F47 service kit item)	2316-38	1	
45	• Bowl, metal	Not normally replaced	1	
46	METAL BOWL, 1990-1995 CONFIGURATION, use with item 15 or 16 Replaced by item 20			
47	• MANUAL DRAIN ASSY, 1/4 turn	619-50	1	
48	• • Valve, drain	617-89	1	
49	• • O-ring	2317-05	1	
50	• AUTOMATIC DRAIN ASSY, 1/8 PTF Outlet *	3000-10	1	
51	• • Nut	2797-89	1	
52	• • Gasket (F47 service kit item)	2811-01	1	
53	• Screw (4380-050 service kit item)	9P06-10	2	
54	• Clamp, sight glass	4323-01	1	
55	• Lens, sight glass (4380-050 service kit item)	4321-89	1	
56	• Seal, sight glass lens (4380-050 service kit item)	4322-99	1	
57	• O-ring, bowl (4380-050 service kit item) (F47 service kit item)	2316-38	1	
58	• Bowl, metal	Not normally replaced	1	
61	METAL BOWL, PRIOR TO 1990 CONFIGURATION, use with item 15 or 16 Replaced by item 20			
62	• MANUAL DRAIN ASSY, 1/4 turn	619-50	1	
63	• • Valve, drain	617-89	1	
64	• • O-ring	2317-05	1	
65	• AUTOMATIC DRAIN ASSY, 1/8 PTF Outlet *	3000-10	1	
66	• • Nut	2797-89	1	
67	• • Gasket (F47 service kit item)	2811-01	1	
68	• Screw (4380-050 service kit item)	9P06-10	2	
69	• Clamp, sight glass	4323-01	1	
70	• Lens, sight glass (4380-050 service kit item)	4321-89	1	
71	• Seal, sight glass lens (4380-050 service kit item)	4322-99	1	
72	• O-ring, bowl (4380-050 service kit item) (F47 service kit item)	2316-38	1	
73	• Bowl, metal	Not normally replaced	1	

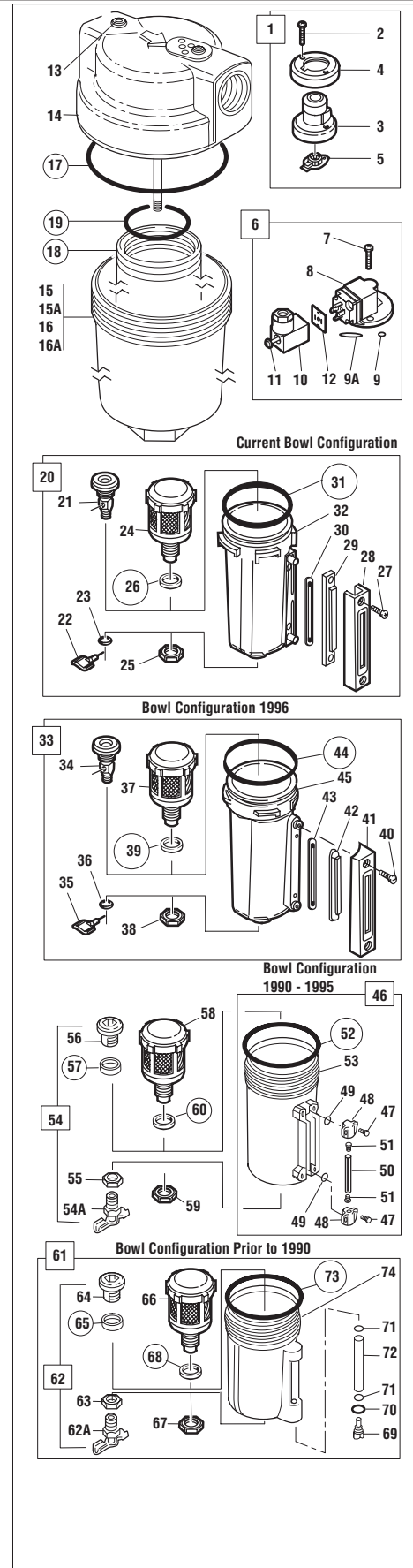

ITEM	DESCRIPTION	PART NO.	QTY	USED ON
46	METAL BOWL ASSY, 1990 - 1995 CONFIGURATION, use with item 15A Bowl has open bottom - also order manual drain (54) or auto drain (58).....	5860-197	1	
47	● Screw (2273-20 service kit item)	3391-05	4	
48	● Bracket	3778-89	2	
49	● O-ring (2273-20 service kit item)	706-01	2	
50	● Gauge glass (2273-20 service kit item).....	5872-01	1	
51	● Seal (2273-20 service kit item).....	5873-83	2	
52	● O-ring (2273-20 service kit item) (F47 service kit item).....	2315-37	1	
53	● Bowl, metal	Not normally replaced	1	
54	MANUAL DRAIN ASSY	2796-52	1	
54A	● Manual drain, petcock	684-01	1	
55	● Nut	2797-89	1	
56	● INSERT AND GASKET ASSY	2796-50	1	
57	● Gasket (F47 service kit item)	2811-01	1	
58	AUTOMATIC DRAIN ASSY, 1/8 PTF Outlet *	3000-10	1	
59	● Nut	2797-89	1	
60	● Gasket (F47 service kit item)	2811-01	1	
61	METAL BOWL ASSY PRIOR TO 1990, use with 15A	Replaced by item 46	1	
62	● MANUAL DRAIN ASSY	2796-52	1	
62A	● Manual drain, petcock.....	684-01	1	
63	● Nut.....	2797-89	1	
64	● INSERT AND GASKET ASSY	2796-50	1	
65	● Gasket (F47 service kit item).....	2811-01	1	
66	● AUTOMATIC DRAIN ASSY, 1/8 PTF Outlet *	3000-10	1	
67	● Nut.....	2797-89	1	
68	● Gasket (F47 service kit item)	2811-01	1	
69	● Retainer.....	Not available	1	
70	● O-ring (2273-08 service kit item).....	720-01	2	
71	● Seal (2273-08 service kit item).....	5873-89	2	
72	● Gauge glass (2273-08 service kit item).....	5872-01	1	
73	● O-ring (F47 service kit item)	2315-37	1	
74	● Bowl, metal	Not normally replaced	1	

SERVICE KITS & ACCESSORIES

F47 service kit, standard element - includes items circled on exploded view3203-02
 F47 service kit, high flow element - includes items circled on exploded view.....3203-05
 Liquid level lens kit for 1996 and current bowls - Items 27, 29, 30, 31, 40, 42, 43, 44.....4380-050
 Liquid level lens kit for 1990 thru 1995 bowl - Items 47, 49, 50, 51, 52.....2273-20
 Liquid level lens kit for bowls prior to 1990- Items 70, 71, 722273-08

* For optional low flow automatic drain with 1/8 PTF outlet, specify 3000-11.
 For standard automatic drain with ISO G1/8 outlet, specify 3000-97.

